

CLC Student Schedule Builder

1 Log In

Go to www.clcillinois.edu
Click myStudentCenter, Log In
Click "Schedule Builder"



2 Click "Schedule Builder"

"Click Here" To Easily Plan Your Class Schedule

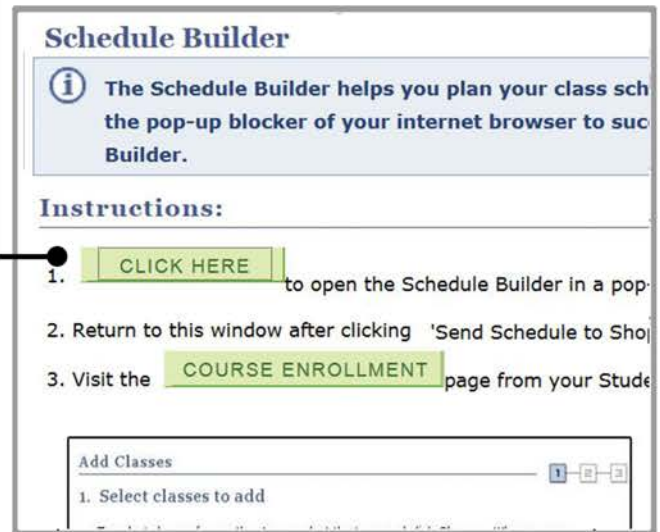

3 Add Courses

To Take Next Term

4 Add Breaks

To Block Off Times For No Class

5 Generate

All Possible Schedules

6 View

To See Schedules

7 Send to Shopping Cart

From the "View" Screen,
Click the "Shopping Cart" Button to Begin Registration!

